



With reference to the proposed grant of a further licence of Units G05 – G07 of the Markets Area Community Resource Organisation (MACRO) Building, Green Street/North King Street, Dublin 7.

By way of licence dated 16th April 2015, Units G05-G07 of the Markets Area Community Resource Organisation (MACRO) Building, Green Street/North King Street, Dublin 7 which said Units are more particularly shown coloured pink on Map Index No. SM2010-0367-001 was let under licence by Dublin City Council to Dublin City Centre Citizens Information Service Limited for a period of 2 years from 1st February 2015. This licence is due to expire on 31st January 2017.

It is proposed to grant a further two year licence to Dublin City Centre Citizens Information Service subject to the following terms and conditions:

1. The proposed licence shall be for the period of 2 years from 1st February 2017 subject to a licence fee of €1.00 if demanded.
2. The proposed licensed area is Units G05-G07 and is more particularly shown coloured pink on Map Index No. SM2010-0367-001.
3. The proposed licence shall be subject to a contribution fee of €12,240 per annum in respect of the cost of managing the building payable quarterly in advance directly to MACRO Building Management CLG who manage the Centre on the Council's behalf.
4. The licensee shall sign a deed of renunciation in respect of the licensed area.
5. The licensee shall be entitled to use the licensed area during the opening hours of the Markets Area Community Resource Organisation building which are 8.00 am to 10.00pm daily.
6. The licence can be terminated by either party on giving the other one months notice in writing.
7. The licensee shall be responsible for all outgoings including waste charges and any water charges which may become payable.
8. The licensee shall keep its part of the premises in good condition and repair during the term of the licence.
9. The licensee shall obtain public liability insurance (€6.5 million) and employer's liability insurance (€13 million) if they have employees and shall indemnify the City Council against any and all claims for compensation, which may arise from their use of their used of the property.
10. On termination of the licence, the licensee shall be responsible for the removal of all their materials from the premises.

11. The licensee shall not assign, sub-let alienate or part with possession of the subject property.
12. The licensee shall not erect any signage on the external or internal walls of the subject property without the prior consent of the Council.
13. The licence will be subject to any terms and conditions deemed appropriate by the Law Agent
14. Each party shall be responsible for its own legal costs.

The area proposed to be licensed is contained in the MACRO Building which is built on lands which form part of the Council's City Estate (Reference AR 208).

The proposed disposal shall be subject to such conditions as to title to be furnished as the Law Agent in his discretion shall stipulate.

No agreement enforceable at law is created or intended to be created until an exchange of contracts has taken place.

This proposal was approved by the Central Area Committee at its meeting on the 10th January 2017.

This report is submitted in accordance with the requirement of Section 183 of the Local Government Act 2001.

Dated this the 16th day of January 2017.

Paul Clegg.
Executive Manager

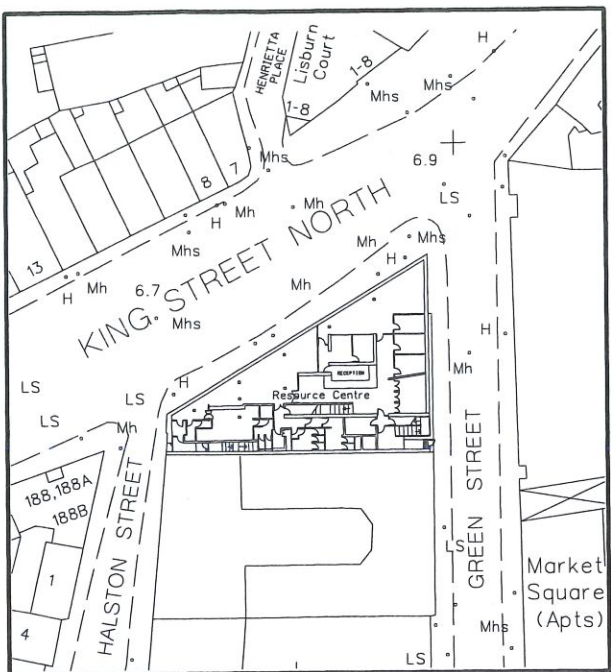

LOCATION MAP SCALE 1:1000

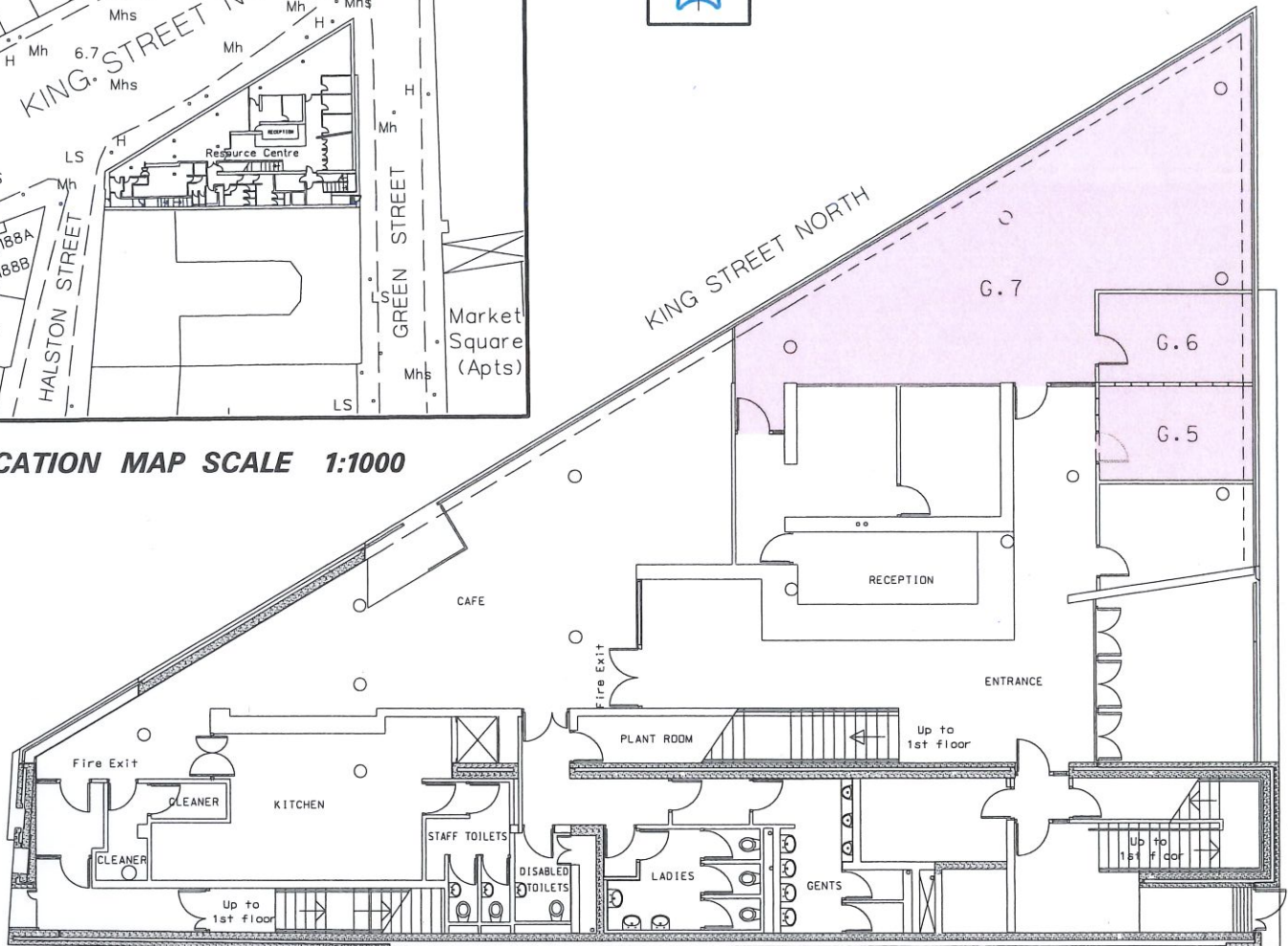

GROUND FLOOR PLAN (SCALE 1:200)

HALSTON STREET /NORTH KING STREET /GREEN STREET - MACRO BUILDING
Rooms G.5, G.6, G.7 (AREA: 97.2 sq m)
Dublin City Council to Dublin City Centre Citizens Information Service
DISPOSAL OF LICENCE



DUBLIN CITY COUNCIL

Comhairle Cathrach Bhaile Átha Cliath
ENVIRONMENT AND ENGINEERING DEPARTMENT
An Roinn Comhshaoil agus Innealtóireachta
SURVEY AND MAPPING SERVICES DIVISION
Rannán Seirbhísi Suirbhéireachta agus Léarscailithe

O.S REF
3263-04, 3263-05

SCALE
1:1000 / 1:200

DATE 12.08.2010
Rev 15-2-2013

**SURVEYED/
 PRODUCED BY**
TJC and FC

INDEX No	FOLDER No	CODE	DWG No	REV
FILE NO SM-2010-0367-0204- C3 - 001 - A.dgn				

FOR PROPERTY REGISTRATION AUTHORITY PURPOSES ONLY
 THIS MAP IS CERTIFIED TO BE COMPUTER GENERATED BY
 DUBLIN CITY COUNCIL FROM ORDNANCE SURVEY DIGITAL MAPBASE

INDEX No.

MICHAEL PHILLIPS
CITY ENGINEER

SIGNED _____
PATRICK SHINE
 MANAGER LAND SURVEYING & MAPPING
 DUBLIN CITY COUNCIL

SM-2010-0367-001